

LIMBACH L 550 E

Four cylinder, horizontally opposed, air cooled, two cycle engine, with solid state magneto ignition, mixture lubrication. Suitable for pusher and tractor installations.

Performance	37 kW (50 HP) at 7500 rpm	Carburators	4 diaphragm all position carburators
Bore	66 mm / 2.60 inch	Starter	12V optional (+ 4.0 kg)
Stroke	40 mm / 1.57 inch	Generator	without
Displacement	548 cm ³ / 33.44 cub. inches	Dry weight approx.	16 kg
Crankcase	Aluminum casting	Fuel	AVGAS 100LL or 90 RON mixed with a suitable oil to the ratio of 1:25 or 1:50 (with synthetic oil)
Crankshaft	Drop forged, seven piece	Optional Equipment:	Cylinders with additional heat sinks (+ 1.2 kg)
Pistons	Cam ground, casted aluminum alloy		Shielded ignition system
Cylinders	Casted aluminum alloy, with nicasil coated barrel		Exhaust stacks
Ignition system	Solid state magneto ignition		
Firing Order	Two opposing cylinders simultaneously, 180 deg. offset		

Limbach Flugmotoren GmbH & Co.KG
Kotthausener Straße 5
D-53639 Königswinter-Sassenberg
Tel. ++49-22 44/92 01-0
Fax ++49-22 44/92 01-30
E-Mail: sales@limflug.de
www.limflug.de

F 2.1

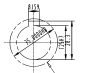
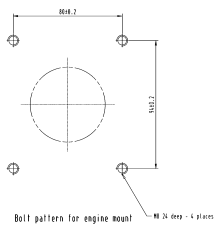

This surface must be polished to R_a 0.8 µm with concentric grooves

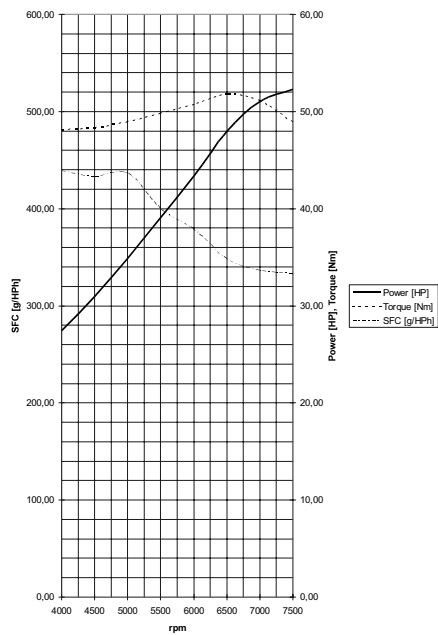
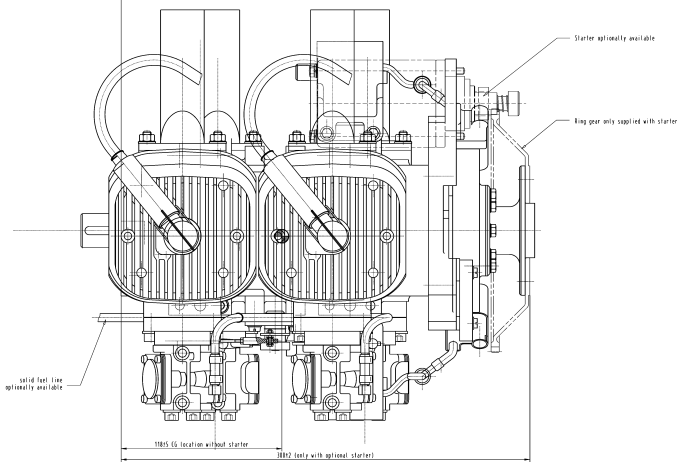
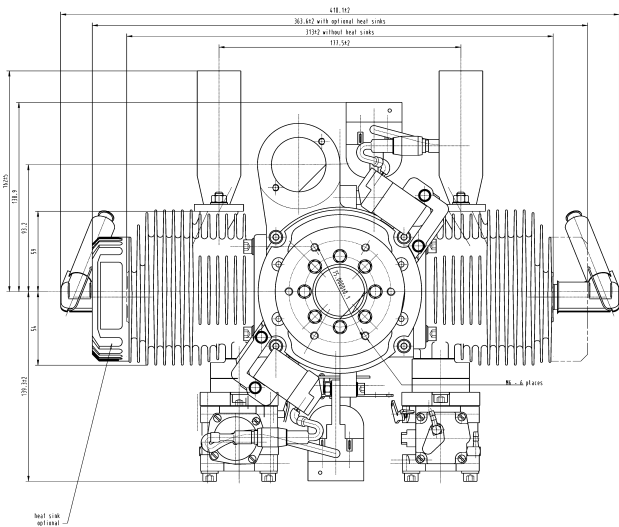
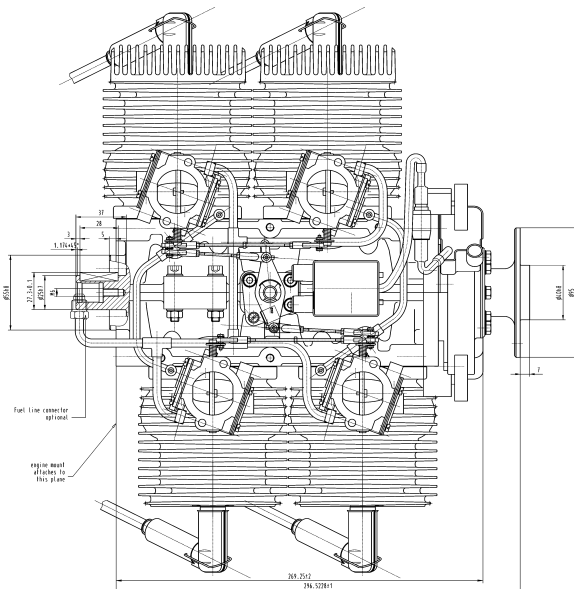

Limbach Flugmotoren GmbH & Co.KG
Kotthausener Straße 5
D-53639 Königswinter-Sassenberg
Tel. ++49-2244/9201-0
Fax ++49-2244/9201-30
E-Mail: sales@limflug.de
www.limflug.de

Data may change without prior notice.