

4. 地上姿勢、又は飛行姿勢のどちらかを選択してください

地上姿勢で作る時

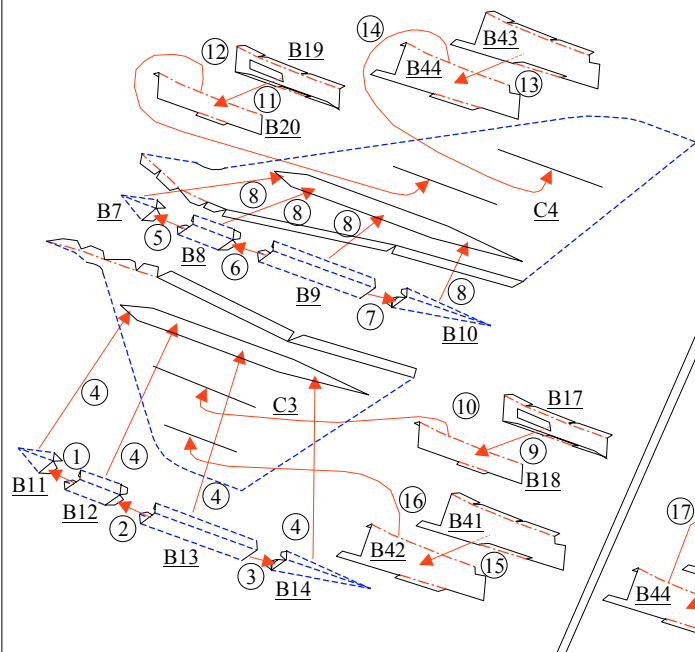

飛行姿勢で作る時

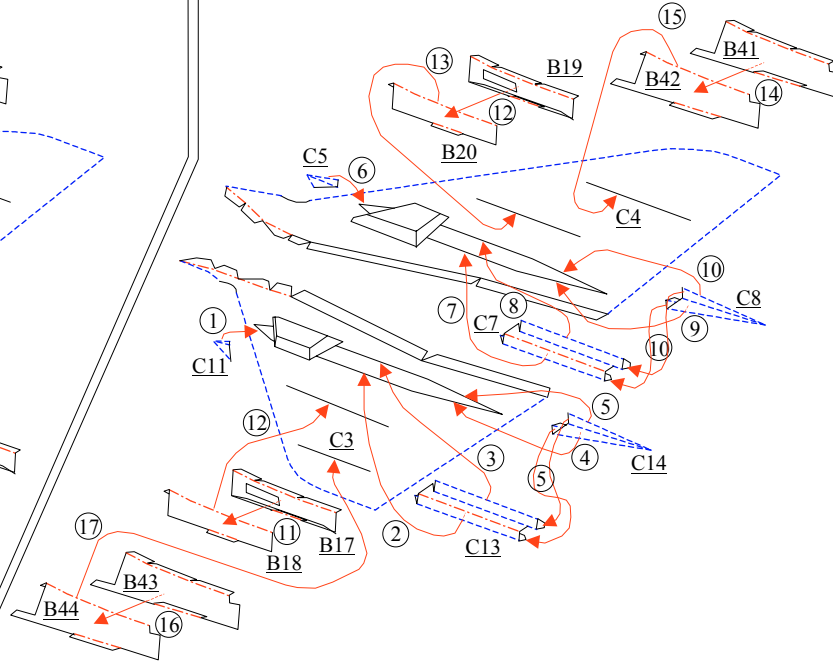

5. 主翼の前だけを接着します、
ここでは後ろ側は接着しません

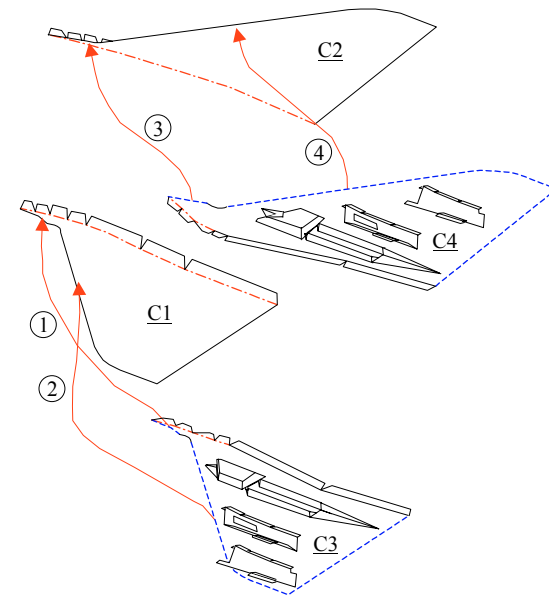

6.

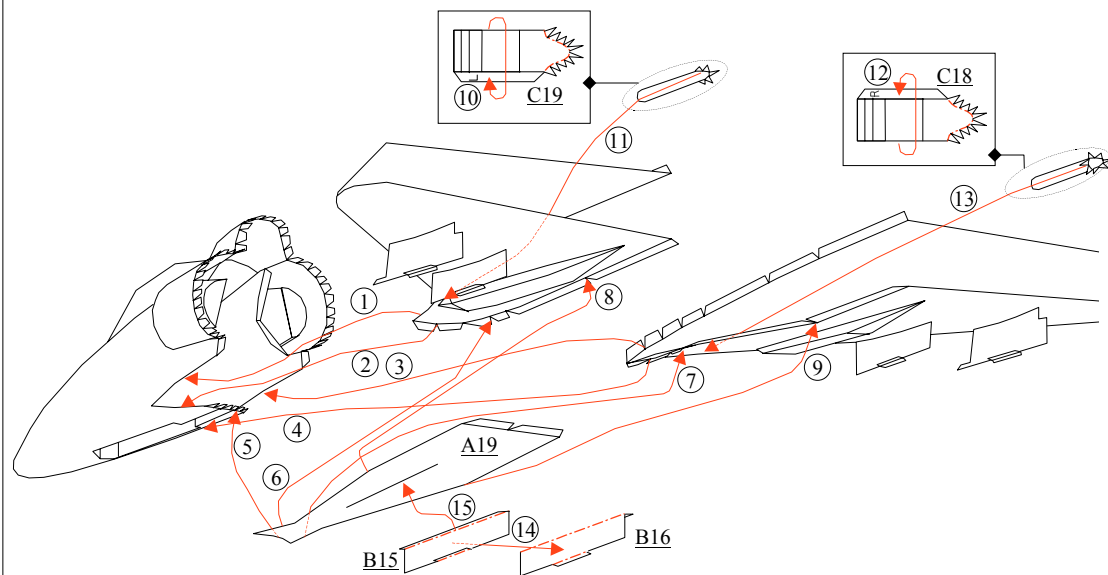

7.

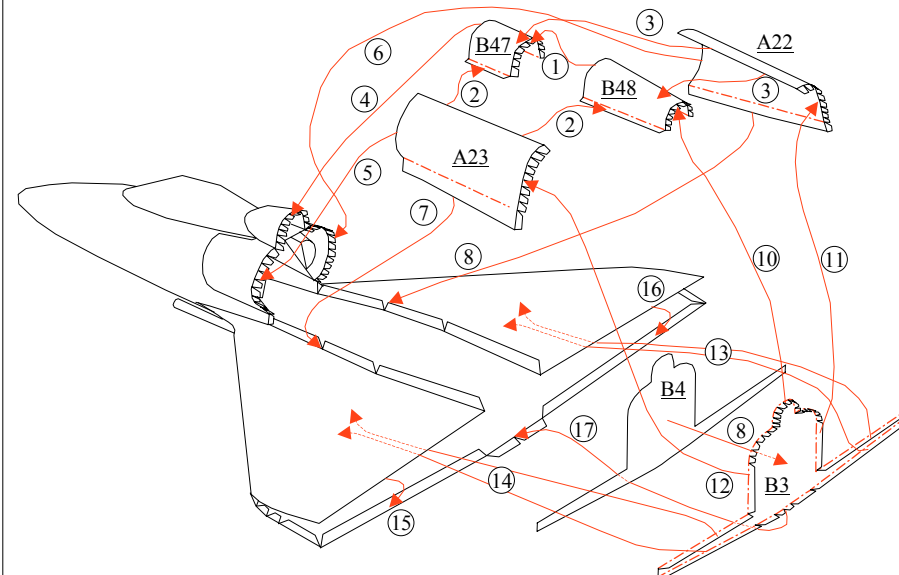

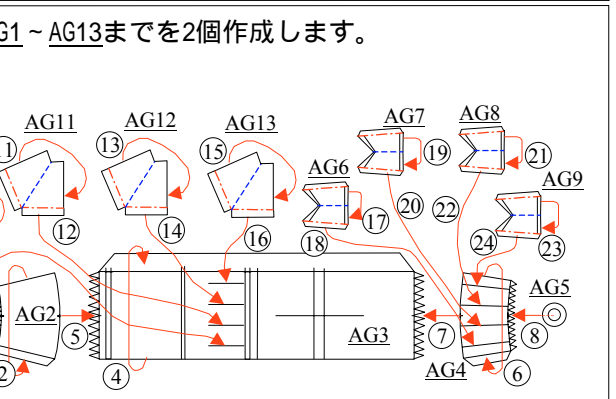
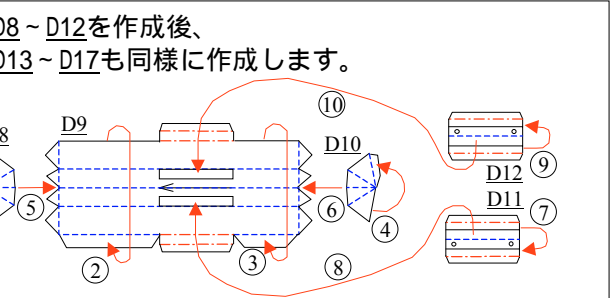
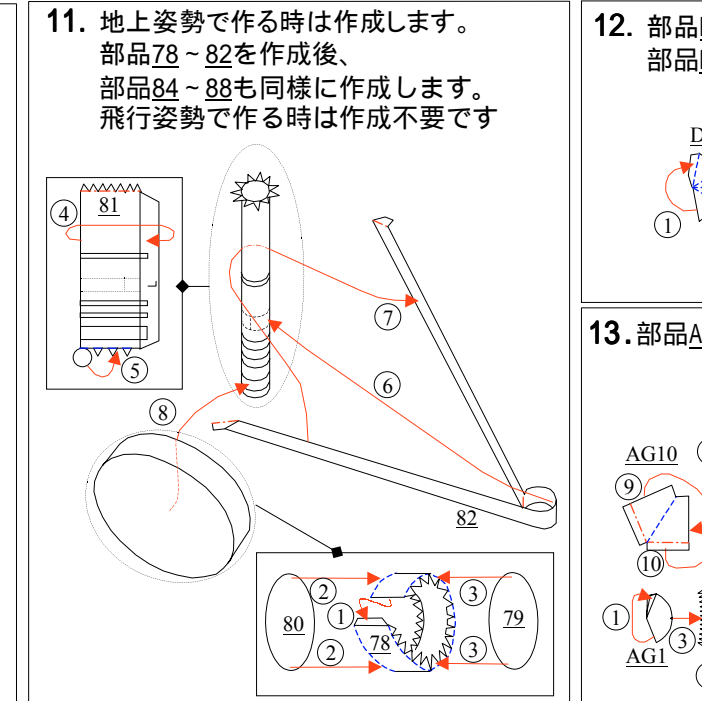
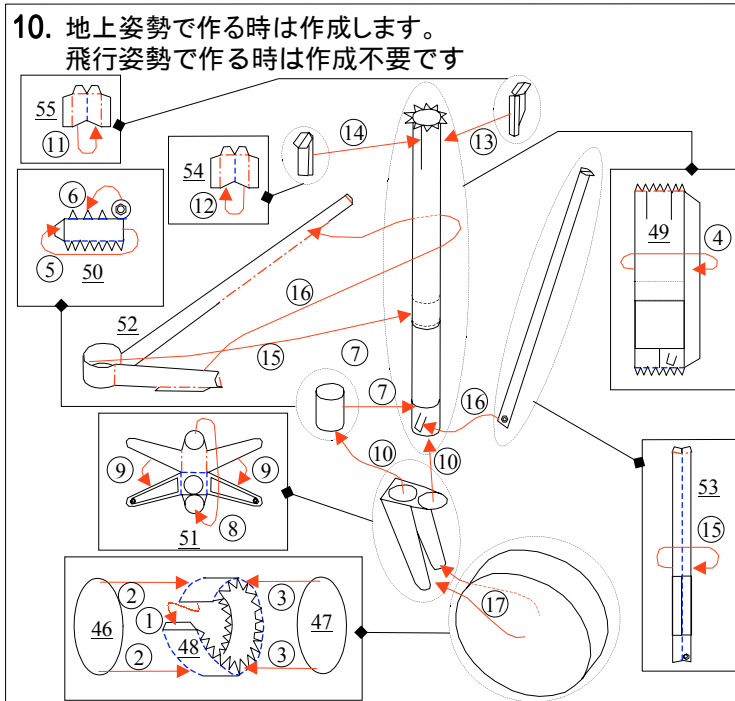
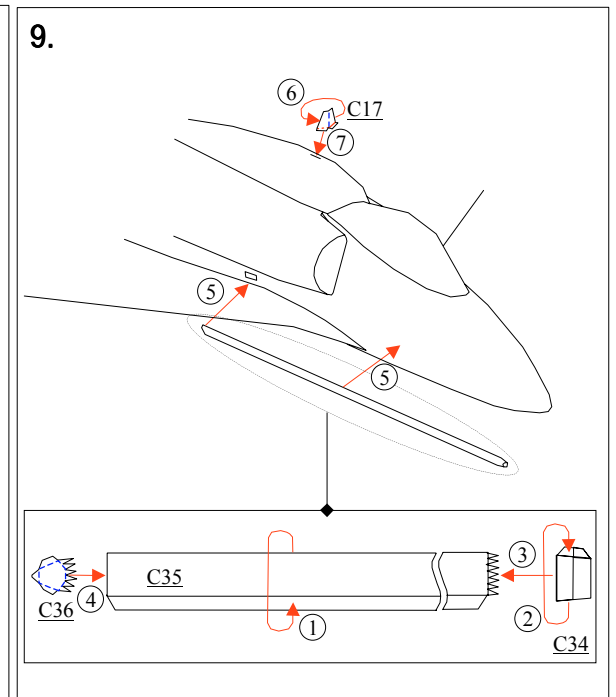
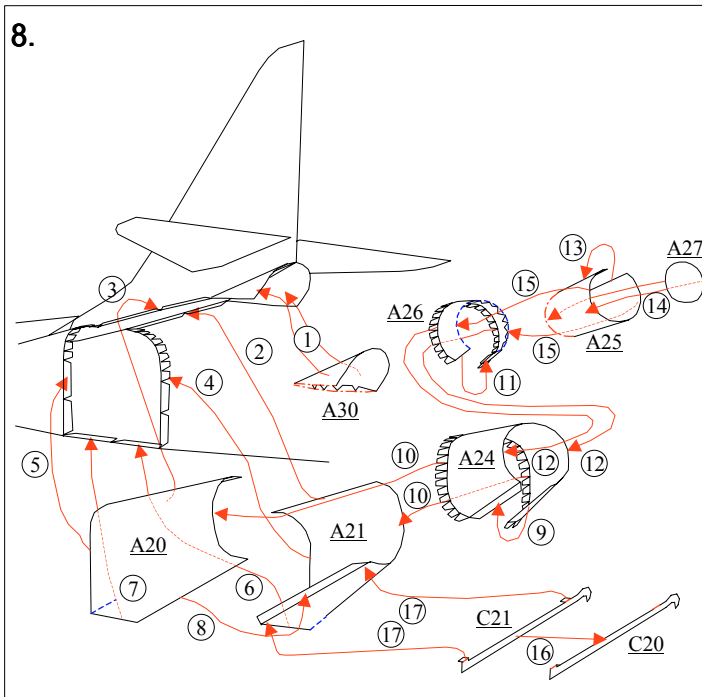
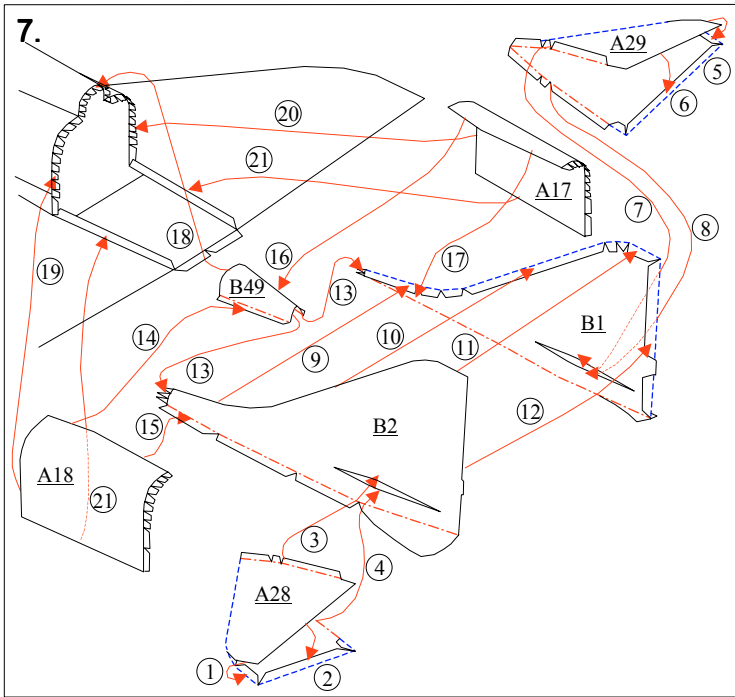

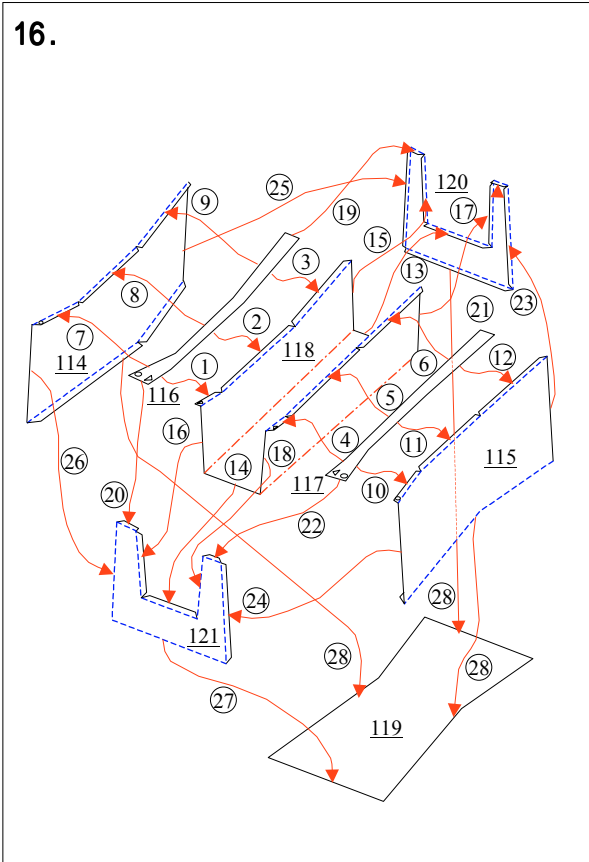
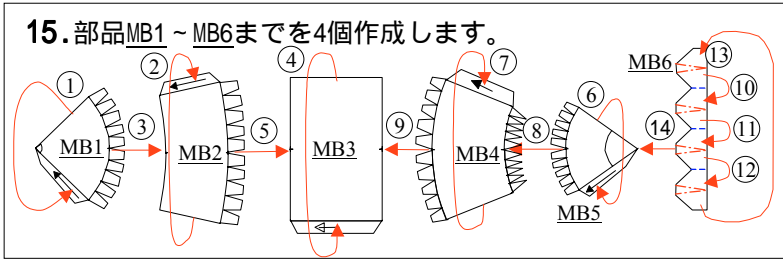
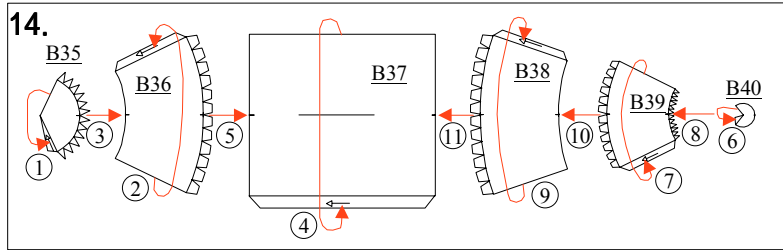

17. 飛行姿勢で作る時は⑳から作成します、地上姿勢の時は最後まで作ります。

